

WELD AS REQUIRED TO WITHSTAND 35 lb PULL.

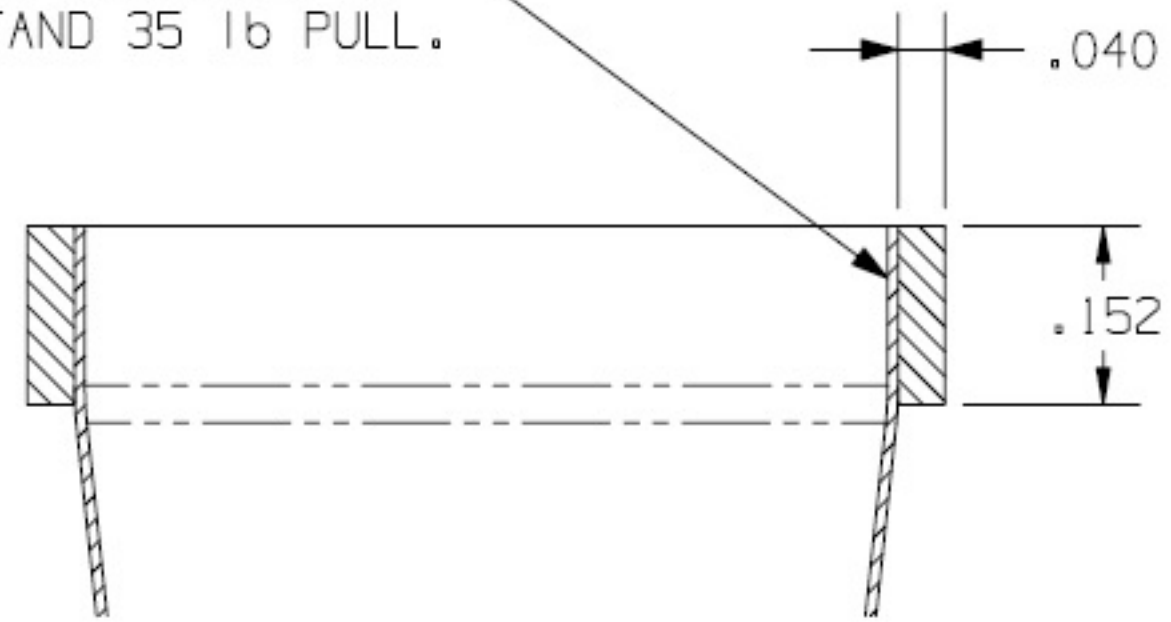

SECTION A - A

NOTE :

- ▲ 1. PART MUST BE CLEAN AND FREE OF BURRS.
- 2. SCREEN MATERIAL: 100 MESH SS WIRE CLOTH, .0045 DIA WIRE, .0055 OPENING, LIKE GRAINGER #3DMF8.
- 3. RING MATERIAL: NON-MAGNETIC STAINLESS, TBD.
- ▲ 4. MUST COMPLY WITH T.P.CO. GLOBAL SPEC 08.

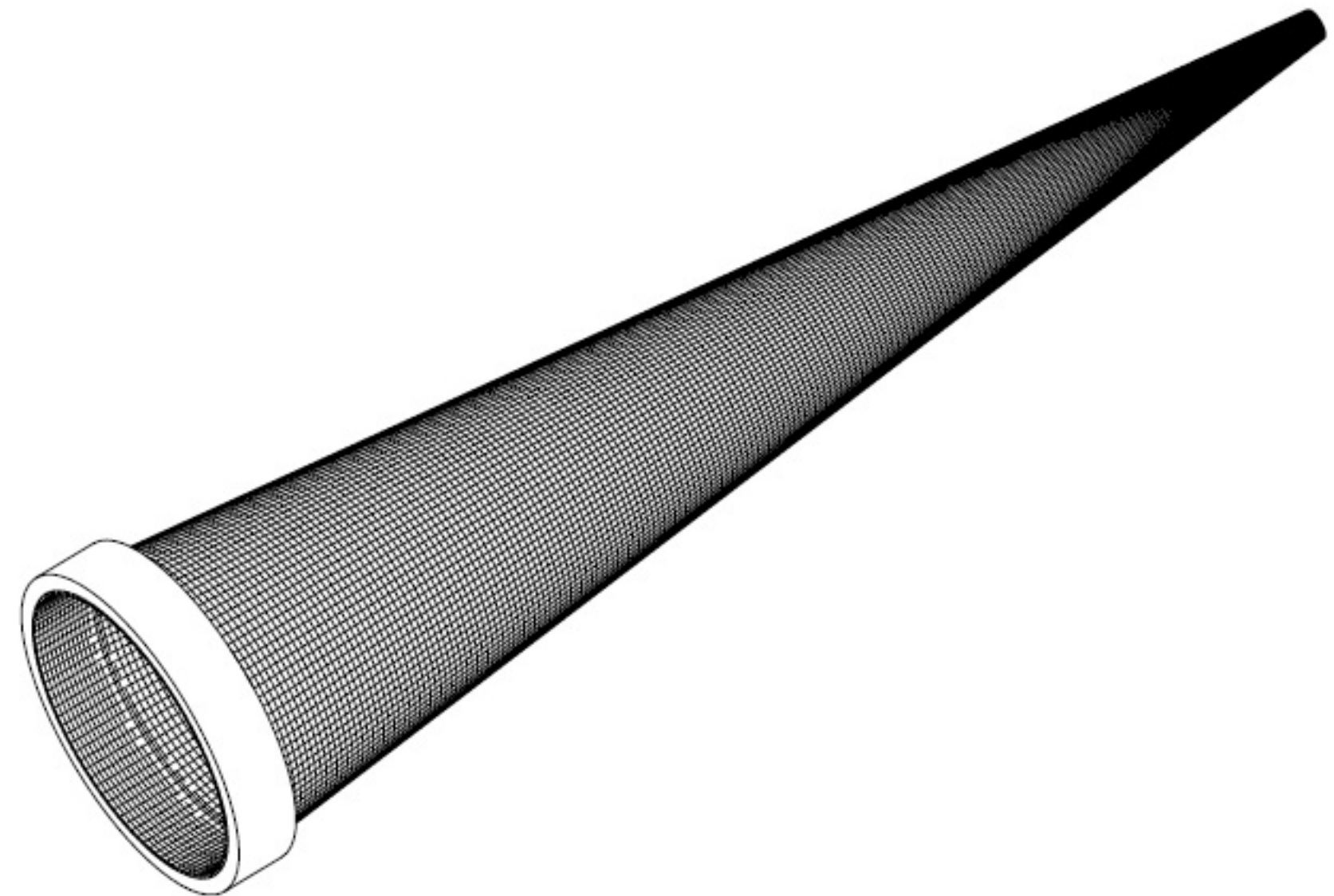
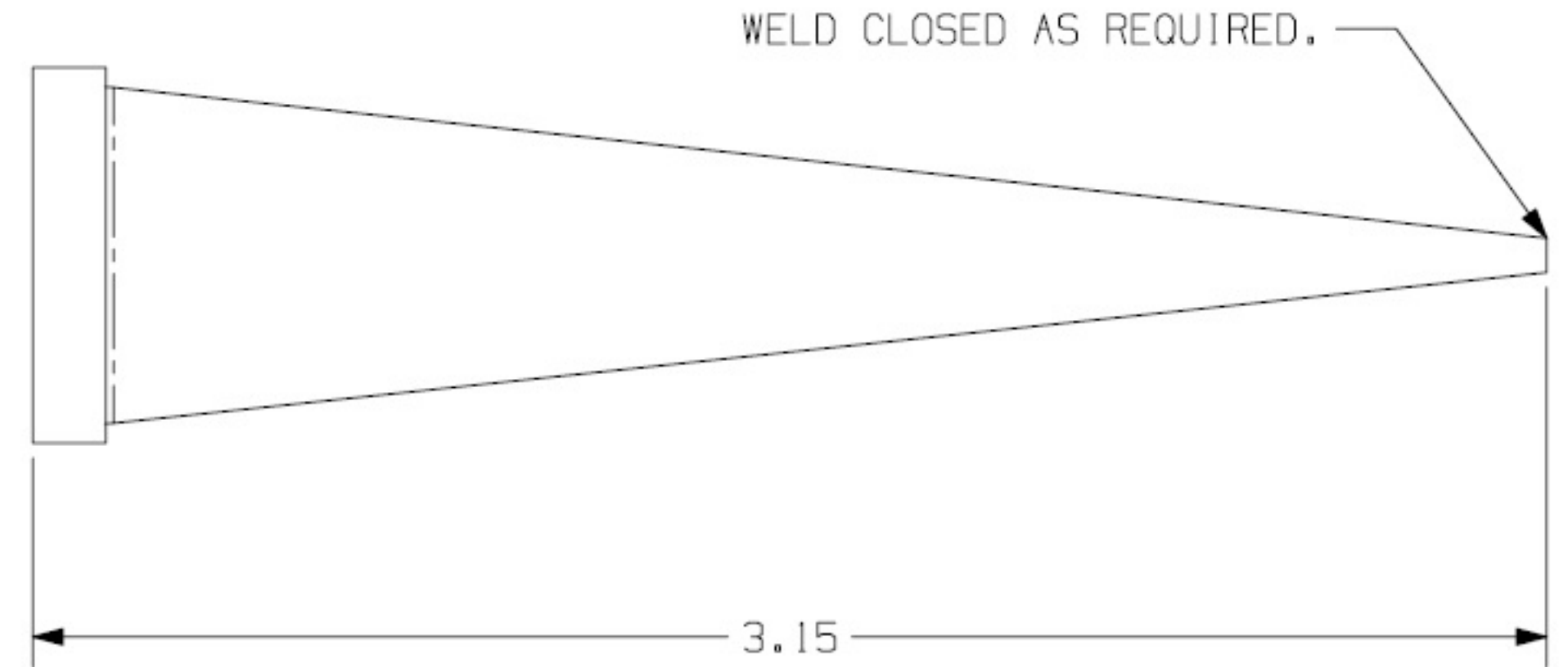

TOLERANCE	UNLESS OTHERWISE SPECIFIED:
2 DEC. PLACE	----- +/- .030 IN.
3 DEC. PLACE	----- +/- .005 IN.